

REV	LOCATIONS	DESCRIPTION	DATE	REVISER	APPD
1	△	Update dimensions	01/NOV/24	MATT	LEO

SPECIFICATIONS

Electrical

Current Rating: 6A AC(rms)/DC  
 Voltage Rating: 150V AC(rms)/DC  
 Contact Resistance: 20 mΩ Max.  
 Insulation Resistance: 1000 MΩ Min.  
 Dielectric strength: 1500V AC /1 Min.  
 Temperature Range-Operating: -40°C~+105°C  
 Screw Torque: 0.10Nm (0.89Lb.in)  
 Wire range: 18~26AWG  
 Strip length: 3.7~4.7mm  
 Max. soldering: 250°C, 5s

Material and Plating

Housing: PA66 (UL 94V-0)  
 Contacts: Brass/ Tin plated  
 Clamp: Steel/ Nickel plated  
 Screw: M1.6 Steel/ Zinc plated

Ordering Information

FTB 254 01 — F XX B 2 GN B  
 1 2 3 4 5 6 7 8 9

1 Category FTB-Terminal Block 2 Series Number 254-Pitch 2.54mm 3 Distinction No. 01 4 Type F-Female

5 Circuits XX 6 Entry Angle B-90° Angle 7 Material-Resin 2-PA66 8 Color-Resin GN-Green 9 Packaging B-PE Bag

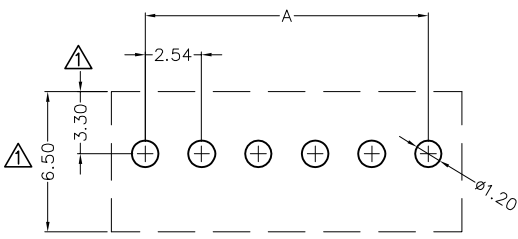
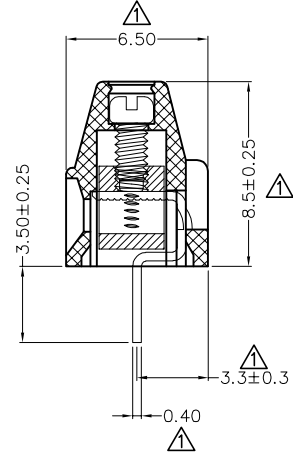
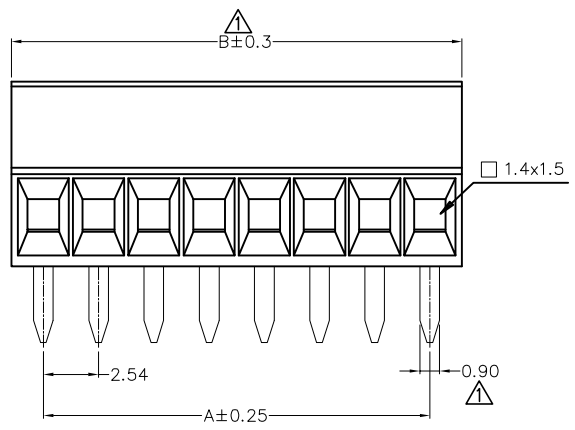
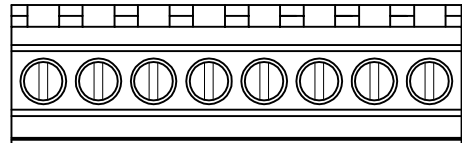

Recommended P.C.Board Layout  
 General Tolerances: ±0.05

Circuits (n)	Part No.	Dimensions(in/mm)		Circuits (n)	Part No.	Dimensions(in/mm)	
		A	B △			A	B △
2	FTB25401-F02B2GNB	2.54	5.48	8	FTB25401-F08B2GNB	17.78	20.72
3	FTB25401-F03B2GNB	5.08	8.02	9	FTB25401-F09B2GNB	20.32	23.26
4	FTB25401-F04B2GNB	7.62	10.56	10	FTB25401-F10B2GNB	22.86	25.80
5	FTB25401-F05B2GNB	10.16	13.10	11	FTB25401-F11B2GNB	25.40	28.34
6	FTB25401-F06B2GNB	12.70	15.64	12	FTB25401-F12B2GNB	27.94	30.88
7	FTB25401-F07B2GNB	15.24	18.18				

<p>THIRD ANGLE PROJECTION</p>	GENERAL TOLERANCES (UNLESS SPECIFIED) X. ±0.30 X.* ±5° X.X ±0.20 X.X* ±2° X.XX ±0.15 X.XX* ±1° X.XXX ±0.10 X.XXX* ±0.5°		APPROVE BY FRANK DATE 12/MAR/21	PART NO. FTB25401-FXXB2GNB ITEM NO. FTB25401	<p>TXGA                  Building Technology Cornerstone</p>
	DESIGN UNITS Metric	CHECKED BY CHERRY DATE 12/MAR/21	DRAWN BY KATE DATE 12/MAR/21	TITLE Terminal Block Pitch 2.54mm 90° Angle (Female) REV 1 SHEET NO. 1/1	
SCALE 5:1	SIZE A4	THIS DRAWING CONTAINS INFORMATION THAT IS PROPRIETARY TO TXGA INDUSTRIAL ELECTRONICS(S.Z)CO.,LTD AND SHOULD NOT BE USED WITHOUT WRITTEN PERMISSION			